



## RACCORDERIA GENERICA GENERIC FITTINGS

### Art.1550

Raccordo dritto femmina/femmina

Straight female connector



La raccorderia generica Tiemme si adatta ad ogni tipo di impianto idraulico domestico e commerciale, applicazioni industriali ed agricole, impianti di riscaldamento, igienico sanitari e generalmente con ogni fluido non corrosivo.

The brass generic fittings are suitable for domestic and commercial plumbing, industrial, agricultural application and generally with every non aggressive fluid.

#### Caratteristiche Tecniche

Temperatura max di esercizio: 200°C  
 Temperatura min di esercizio: -20°C  
 Pressione max di esercizio: 30 bar  
 Filettature: femmina UNI ISO 228

#### Technical Features

Maximum temperature: 200°C  
 Minimum temperature: -20°C  
 Maximum operating pressure: 30 bar  
 Threads: female UNI ISO 228

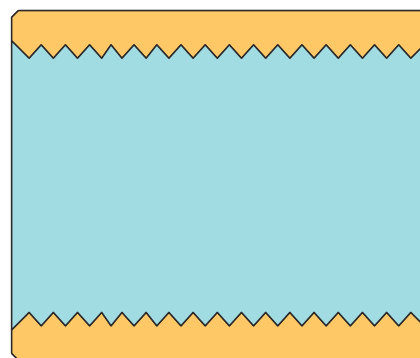

#### Tabella dimensioni / Sizes table

F	G	CODICE / CODE	L	ØA	ØB
1/4"	1/4"	150 0692	22,0	16,8	16,8
3/8"	3/8"	150 0319	23,0	22	22
1/2"	3/8"	150 0288	24,5	27	21,5
1/2"	1/2"	150 0034	31,0	26	26
3/4"	1/2"	150 0046	25,0	35	27
3/4"	3/4"	150 0047	33,0	32	32
1"	1/2"	150 0080	30,0	42	27
1"	3/4"	150 0059	30,5	42	32
1"	1"	150 0032	39,0	40	40
1 1/4"	1"	150 0110	43,5	51	42
1 1/4"	1 1/4"	150 0122	45,0	50	50
1 1/2"	1 1/2"	150 0131	50,0	57	57
2"	2"	150 0135	58,0	72	72
2 1/2"	2 1/2"	150 0386	65,0	89	89
4"	4"	150 0511	80,0	130	130

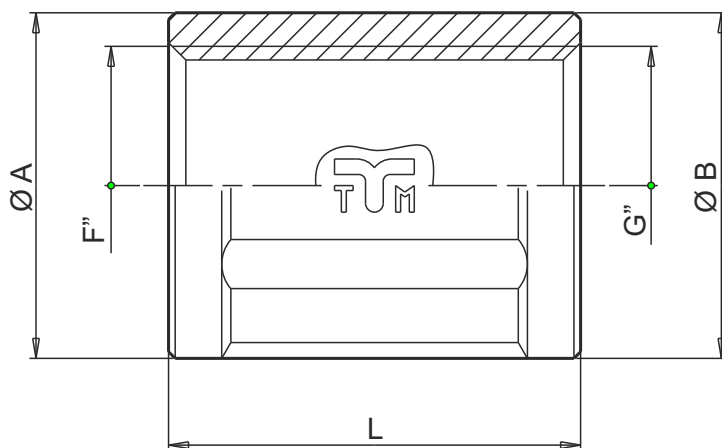

Descrizione	Materiale	Trattamento	Description	Material	Treatment
Corpo	Ottone CW617N - EN12165	-	Body	CW617N - EN12165 brass	-

**TIEMME Raccorderie S.p.A.**  
 Via Cavallera 6/A (Loc. Barco) - 25045 Castegnato (Bs) - Italy  
 Tel +39 030 2142211 R.A. - Fax +39 030 2142206  
 info@tiemme.com - www.tiemme.com

TIEMME Raccorderie S.p.A. si riserva di apportare modifiche in qualsiasi momento senza preavviso. È vietata qualsiasi forma di riproduzione, se non autorizzata.  
 TIEMME Raccorderie S.p.A. reserves the right to modify contents in any time without prior advise. Is forbidden any reproduction unless under TIEMME authorization